

Job or Customer :	
Location :	
Engineer :	
<input type="checkbox"/> Complies with Spec <input type="checkbox"/> Alternate	Notes :
Contractor :	
HeatLink Rep :	
Submitted By :	Date :
Approved By :	Date :
P.O. Number :	Date :

### Description

Solid no lead (Eco) Brass PEX F1960 × MNPT elbows for PEX-a potable water expansion systems.

*The use of PEX tubing in a potable hot-water plumbing system with an operating temperature above 140°F (60°C) or system pressure above 80 psig (550 kPaG) or highly aggressive water quality or any combination thereof can significantly reduce the service life of the tubing.*

*HeatLink requires following the guidelines described in Plastics Pipe Institute TN-53, Guide to Chlorine Resistance Ratings of PEX Pipes and Tubing for Potable Water Applications and HeatLink INFO 37, Domestic Hot Water Recirculation Systems.*

Qty	Stk. #	Size	Dimension, in/(mm)								Weight, lb/(kg)
			A	B	C	D	E	F	ID1	ID2	
	EX28505NL	½ PEX × ½ MNPT	0.71 (18.0)	0.57 (14.5)	0.42 (10.6)	0.35 (9.0)	0.35 (9.0)	0.55 (14.0)	0.38 (9.7)	0.59 (15.0)	0.097 (0.044)

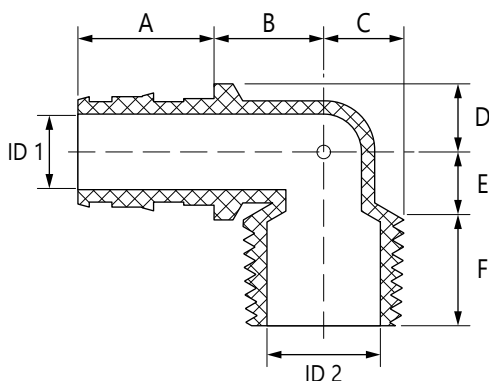

**Listings**  
 ICC-ES PMG 1087  
 cNSFus-pw  
 cQALus P371  
 U.P. Code

**Codes**  
 IMC  
 IPC  
 IRC  
 NPC of Canada  
 NSPC  
 UMC  
 UPC

**Standards**  
 ASTM E84  
 ASTM F877  
 ASTM F2159  
 CSA B137.5  
 NSF/ANSI 14  
 NSF/ANSI 61  
 NSF/ANSI 372  
 ULC S102.2

### Technical Data

	Specifications
Material	No Lead (Eco) Brass - C69300
Operating pressure rating	180°F @ 100 psi (82.2°C @ 0.69 MPa)

### Installation

Installation must follow all of HeatLink's instructions and guidelines.

### Related Documents

- F1960 PEX-a Potable Water Expansion System Installation Guide (L3240)
- HeatLink Limited Plumbing Warranty