

Job or Customer :	
Location :	
Engineer :	
<input type="checkbox"/> Complies with Spec <input type="checkbox"/> Alternate	Notes :
Contractor :	
HeatLink Rep :	
Submitted By :	Date :
Approved By :	Date :
P.O. Number :	Date :

**Description**

No lead brass 3/4" PEX F1960 x 3/4" MNPT full port straight ball valves with butterfly handle.

*The use of PEX tubing in a potable hot-water plumbing system with an operating temperature above 140°F (60°C) or system pressure above 80 psig (550 kPaG) or highly aggressive water quality or any combination thereof can significantly reduce the service life of the tubing.*

*HeatLink requires following the guidelines described in Plastics Pipe Institute TN-53, Guide to Chlorine Resistance Ratings of PEX Pipes and Tubing for Potable Water Applications and HeatLink INFO 37, Domestic Hot Water Recirculation Systems.*

Qty	Stk. #	Size	Dimension, in/(mm)						ID	Weight, lb/(kg)
			A	B	C	D	E			
	EX23822NL	3/4" MNPT x PEX	1.22 (31)	2.43 (61.8)	2.24 (56.8)	2.85 (72.3)	1.22 (30.9)	0.61 (15.5)	0.49 (0.220)	

**Technical Data**

Specifications	
Materials	Body No Lead (C46500) Brass
	Seat PTFE
	Ball Stainless steel
	Packing PTFE
	O-ring NBR
	Stem Brass
	Handle nut Plated steel
	Lock washer Plated steel
	Handle Aluminum alloy
	Packing nut Brass
	Cap No Lead (C46500) Brass
Operating pressure rating	180°F @ 100 psi (82.2°C @ 0.69 MPa)

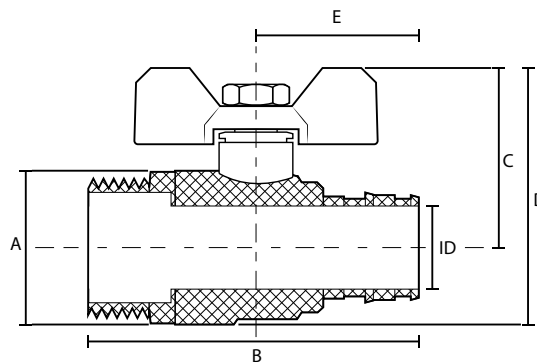

Listings	Standards
IAPMO cUPC	ASTM F1960 compliant
	IAPMO/ANSI Z1157
Codes	NSF/ANSI 14
UPC	NSF/ANSI 61
NPCC	NSF/ANSI 372

**Installation**

Installation must follow all of HeatLink's instructions and guidelines.

**Related Documents**

- HeatLink Limited Plumbing Warranty