

Job or Customer :	
Location :	
Engineer :	
<input type="checkbox"/> Complies with Spec <input type="checkbox"/> Alternate	Notes :
Contractor :	
HeatLink Rep :	
Submitted By :	Date :
Approved By :	Date :
P.O. Number :	Date :

Description

High Performance Polymer PEX F1960 × MNPT adapters for use with PEX-a potable water expansion systems.

Qty	Stk. #	Size (PEX × MNPT)	Dimension, in/(mm)							Weight, lb/(kg)
			A	B	C	D	E (ø)	ID 1	ID 2	
	EX17505	½" PEX × ½" MNPT	0.71 (18.0)	0.20 (5.1)	0.73 (18.5)	0.88 (22.4)	0.99 (25.1)	0.40 (10.0)	0.59 (14.9)	0.015 (0.007)
	EX17552	½" PEX × ¾" MNPT	0.71 (18.0)	0.20 (5.1)	0.73 (18.5)	1.12 (28.5)	1.23 (31.2)	0.40 (10.0)	0.75 (19.1)	0.021 (0.010)
	EX17522	¾" PEX × ¾" MNPT	0.94 (23.8)	0.20 (5.1)	0.73 (18.5)	1.12 (28.5)	1.23 (31.2)	0.60 (15.2)	0.75 (19.1)	0.030 (0.014)

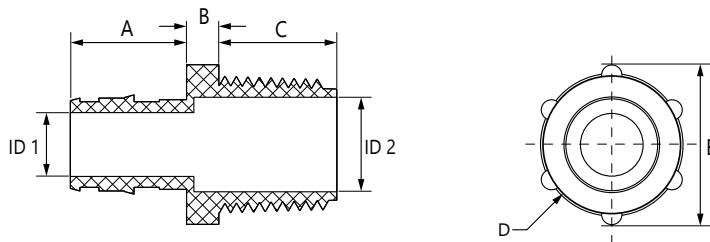

Technical Data

Specifications

Material	PPSU
Operating Pressure rating	180°F @ 100psi (82.2°C @ 0.69MPa)

Listings

ICC-ES PMG 1087
cNSFus-pw
cQAlus P371

Codes

IMC
IPC
IRC
NPC of Canada
NSPC
UMC
UPC

Standards

ASTM E84
ASTM F1960
ASTM F877
CSA B137.5
NSF/ANSI 14
NSF/ANSI 61
NSF/ANSI 372
ULC S102.2

Installation

Installation must follow all of HeatLink's instructions and guidelines.

Related Documents

- PEX-a F1960 Potable Water Expansion System Installation Guide (L3240)
- HeatLink Limited Plumbing Warranty

This page is intentionally blank.