

Job or Customer :	
Location :	
Engineer :	
<input type="checkbox"/> Complies with Spec <input type="checkbox"/> Alternate	Notes :
Contractor :	
HeatLink Rep :	
Submitted By :	Date :
Approved By :	Date :
P.O. Number :	Date :

Description

Galvanized steel support for HeatLink PEX-a tubing.

Qty	Stk. #	Size	Description	Length in. (mm)	Width in. (mm)	Height in. (mm)	Weight lb (kg)
	88205	1/2"	1/2" 9ft PEX-a Tubing Support	108" (2,743 mm)	0.68" (17.29 mm)	0.41" (10.37 mm)	1.1 lb (0.5 kg)
	88222	3/4"	3/4" 9ft PEX-a Tubing Support	108" (2,743 mm)	0.92" (23.44 mm)	0.55" (14.07 mm)	1.5 lb (0.7 kg)
	88228	1"	1" 9ft PEX-a Tubing Support	108" (2,743 mm)	1.17" (29.62 mm)	0.70" (17.82 mm)	1.9 lb (0.9 kg)
	88235	1-1/4"	1-1/4" 9ft PEX-a Tubing Support	108" (2,743 mm)	1.35" (34.23 mm)	0.76" (19.35 mm)	2.1 lb (1.0 kg)
	88241	1-1/2"	1-1/2" 9ft PEX-a Tubing Support	108" (2,743 mm)	1.54" (39.05 mm)	0.93" (23.56 mm)	2.8 lb (1.3 kg)
	88254	2"	2" 9ft PEX-a Tubing Support	108" (2,743 mm)	2.14" (54.47 mm)	1.32" (33.52 mm)	3.6 lb (1.6 kg)

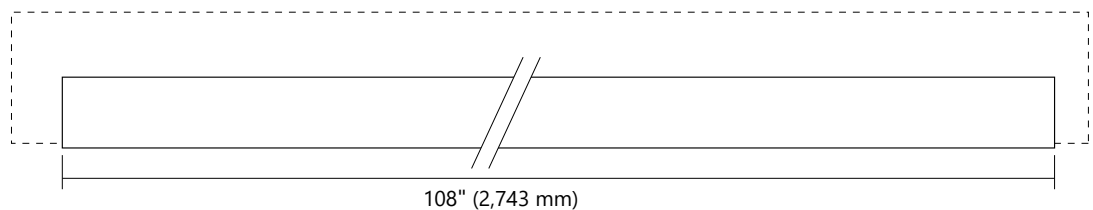
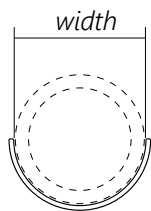

Technical Data

Material:.....23ga Galvanized Steel

This page is intentionally blank.