

Job or Customer :	
Location :	
Engineer :	
<input type="checkbox"/> Complies with Spec <input type="checkbox"/> Alternate	Notes :
Contractor :	
HeatLink Rep :	
Submitted By :	Date :
Approved By :	Date :
P.O. Number :	Date :

Description

Used to couple together 1-1/4" stainless steel manifolds (75100 & 75200 series). Each kit contains a pair of couplings.

Qty	Stk. #	A	B	Weight
	76946	1" (25 mm)	1.77" (45 mm)	0.6 lb (0.27 kg)

Technical Data

Specifications

Materials

Forged components	Brass alloy UNI-EN 12165 CW617N
Machined components	Brass alloy UNI-EN 12164 CW614N
O-ring	EPDM
Operating temp. range	32-203°F (0-95°C)
Max. operating pressure	145 psi (1000 kPa)

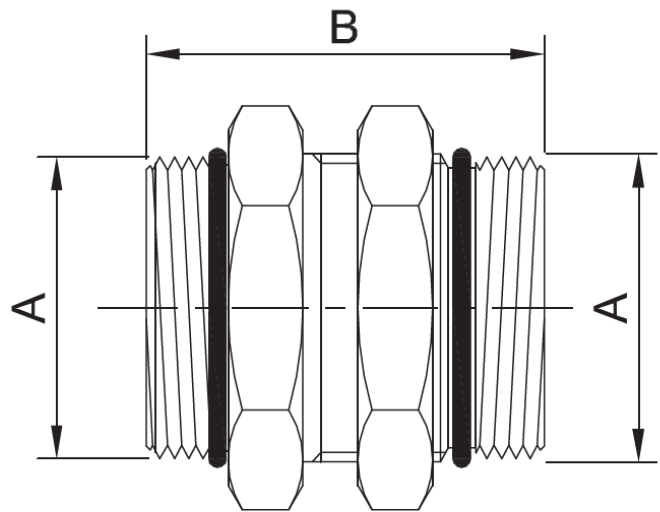

Installation & Maintenance

Installation must follow all of HeatLink's instructions and guidelines.

Related Documents

- HeatLink Limited Heating Warranty

This page is intentionally blank.