

Job or Customer :	
Location :	
Engineer :	
<input type="checkbox"/> Complies with Spec <input type="checkbox"/> Alternate	Notes :
Contractor :	
HeatLink Rep :	
Submitted By :	Date :
Approved By :	Date :
P.O. Number :	Date :

### Description

The 31667 Snow/Ice Detector & Melting Control is designed to control a single zone snow melting system. The snow melting system may be started manually or automatically through the use of a Snow / Ice Sensor 30090. The control automatically adjusts the mixed supply water to the snow melting system by controlling a variable speed pump or floating action mixing valve. The 31667 control includes a large Liquid Crystal Display (LCD) in order to view system status and operating information.

### Technical Data

Ambient Conditions: ..... Indoor use only, 32 to 104°F (0 to 40°C),  
<90% RH noncondensing

Enclosure Material:..... Red PVC plastic

Operating Voltage:..... 120V(ac) ±10% 50/60 Hz

Power Consumption: ..... 600 VA (includes max. power to mixing actuator)

Relays:..... 230V(ac) 5A 1/3 hp, pilot duty 240 VA

Var. Pump: ..... 230 V(ac) 2.4A 1/6 hp, fuse T2.5 A 250V

Demands: ..... 20 to 260 V(ac) 2 VA

Sensors: ..... NTC thermistor, 10 kΩ @ 77°F  
(25°C ± 0.2°C) β = 3892

Included: ..... Universal Sensor 30071 x2 and  
Outdoor Sensor 30070

Optional:..... Indoor Sensor 30076, 30077

### Standards / Listings

- CSA C US, meets ICES & FCC regulations for EMI/RFI

Qty	Stk. #	Dimensions			Weight
		A	B	C	
	31667	7-9/16" (193 mm)	6-5/8" (170 mm)	2-13/16" (72 mm)	3.75 lb 1.7 kg

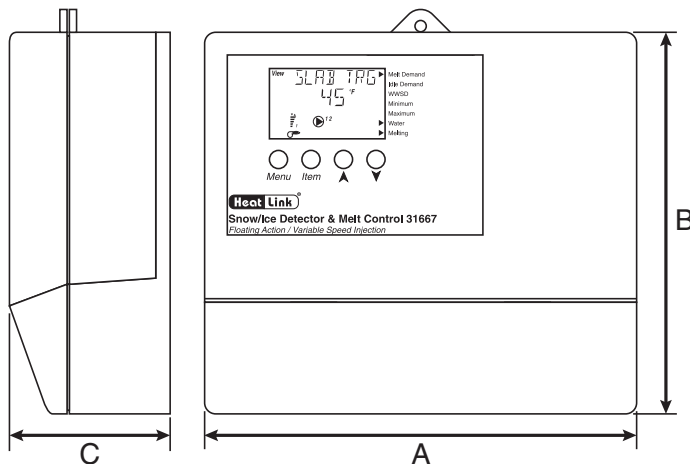

**Sample Wiring Diagram**

Illustration only, not for construction,  
see mechanical specification.

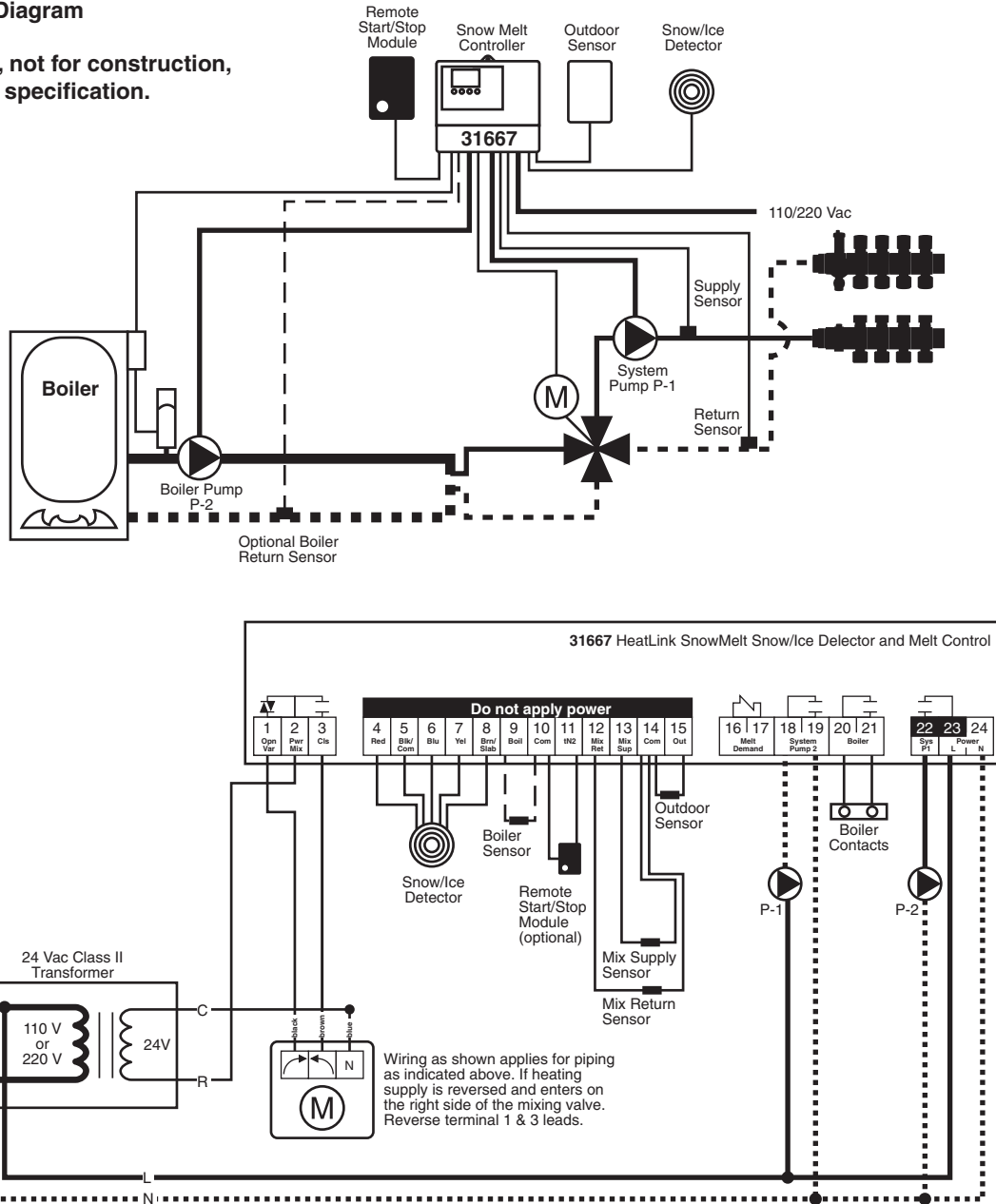

**Installation**

Installation of must follow all of HeatLink's instructions and guidelines, including those in the installation instructions.

**Related Documents**

- 31667 Installation Instructions (L631667D)
- 31667 User Guide (L631337U)
- Component Warranty