

**43302 Wireless Relay**



Installer/User Manual

HeatLink Group, Inc.  
www.heatlink.com

Printed in Canada  
July 11, 2018

L643302 Wireless Relay Instructions

**Product Compliance**

This equipment has been tested and found to comply with the limits for a Class B digital device, pursuant to Part 15 of the FCC Rules. These limits are designed to provide reasonable protection against harmful interference in a residential installation. This equipment generates uses and can radiate radio frequency energy and, if not installed and used in accordance with the instructions, may cause harmful interference to radio communications. However, there is no guarantee that interference will not occur in a particular installation. If this equipment does cause harmful interference to radio or television reception, which can be determined by turning the equipment off and on, the user is encouraged to try to correct the interference by one or more of the following measures:

- Reorient or relocate the receiving antenna.
- Increase the separation between the equipment and receiver.
- Connect the equipment into an outlet on a circuit different from that to which the receiver is connected.
- Consult the dealer or an experienced radio/TV technician for help.

Changes or modifications not expressly approved by the party responsible for compliance could void the user's authority to operate the equipment.

This device complies with part 15 of the FCC Rules. Operation is subject to the following two conditions: (1) This device may not cause harmful interference, and (2) this device must accept any interference received, including interference that may cause undesired operation.

This device complies with Industry Canada's licence-exempt RSSs. Operation is subject to the following two conditions:

- (1) This device may not cause interference; and
- (2) This device must accept any interference, including interference that may cause undesired operation of the device.

Le présent appareil est conforme aux CNR d'Industrie Canada applicables aux appareils radio exempts de licence. L'exploitation est autorisée aux deux conditions suivantes :

- (1) l'appareil ne doit pas produire de brouillage, et
- (2) l'utilisateur de l'appareil doit accepter tout brouillage radioélectrique subi, même si le brouillage est susceptible d'en compromettre le fonctionnement.

**Overview**

The HeatLink® 43302 Wireless Relay can be configured as a boiler switch, or as a single room switch.

The HeatLink® Smart System can be configured with an internet connection (Online), or without (Offline). The free HeatLink® App must be downloaded to your Apple or Android device for use with your Online Smart System.



In order to use the app you must first create a profile. Follow the in app instructions to set up your profile.

Apple, the Apple logo, iPhone, and iPod touch are trademarks of Apple Inc., registered in the U.S. and other countries. App Store is a service mark of Apple Inc., registered in the U.S. and other countries.

Google Play and the Google Play logo are trademarks of Google LLC.

**System Components**

Additional components may be necessary to operate your HeatLink® Smart System. For details on component operation and installation, see the individual user guides, or the L3715 Smart System Installation Manual.



A 43301 Wireless Internet Gateway (sold separately) is needed for all HeatLink® Smart Systems to function.

The HeatLink® 46801 Wireless Thermostat has an easy to use interface, and a sleek modern design. It can be configured to work with a variety of radiant heating systems.

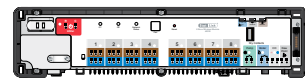

The 40328 StatLink® 8 Zone Wireless Module connects your wireless thermostats to the zone actuators, boiler, system pump, etc.

The 56401 Wireless Valve Actuator is easily installed on a radiator valve to supply even heat to a room. Can be used in Online or Offline systems.



The 43303 Door/Window Sensor requires an Online system to operate, and allows you monitor your home windows and doors, as well as set custom programs for system operation (using the app).

The 43304 Smart Plug requires an Online system to operate, and allows you to control the on/off function of lights and some electronics, and set custom programs for system operation (using the app).



**Wireless Relay LED Indications**

Switch/LED	Action
Auto	The relay output will switch on and off under command from the HeatLink Smart Home system.
Manual	The relay output is controlled by the On/Off slide switch.
Solid Red LED	Power.
Solid Green LED	Relay contacts closed; the connected device will be switched on.
Single Flashing Red LED	Relay is ready for pairing.
Double Flashing Red LED	Left network.

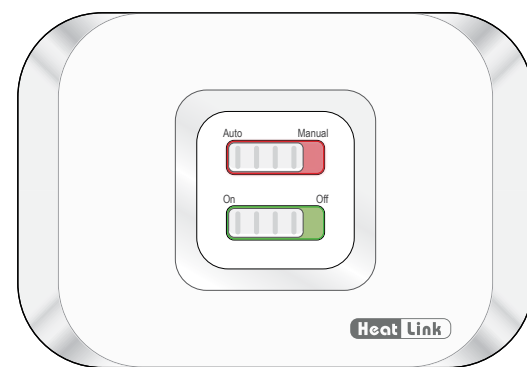

**Wiring - Wireless Relay (RX1)**

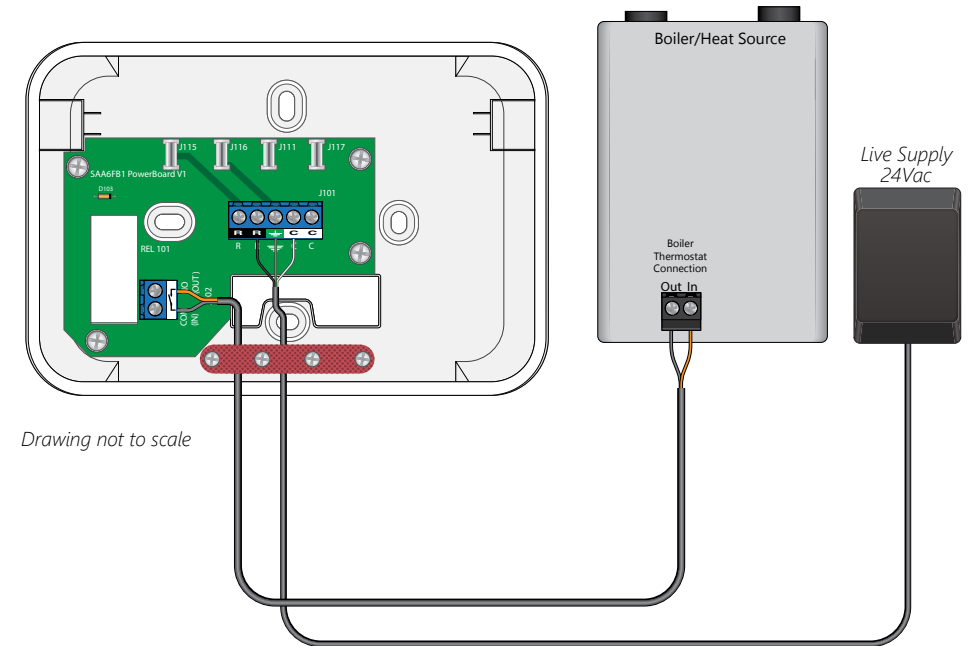

Drawing not to scale



This product must be installed by a qualified installer/service technician, and must be installed and operated in strict accordance with the terms set out in this manual and in accordance with the relevant requirements of the Local Authority Having Jurisdiction. Failure to comply will result in a void of warranty, and may also result in property damage, serious injury, or death.

**Wiring - Wireless Relay (RX2)**

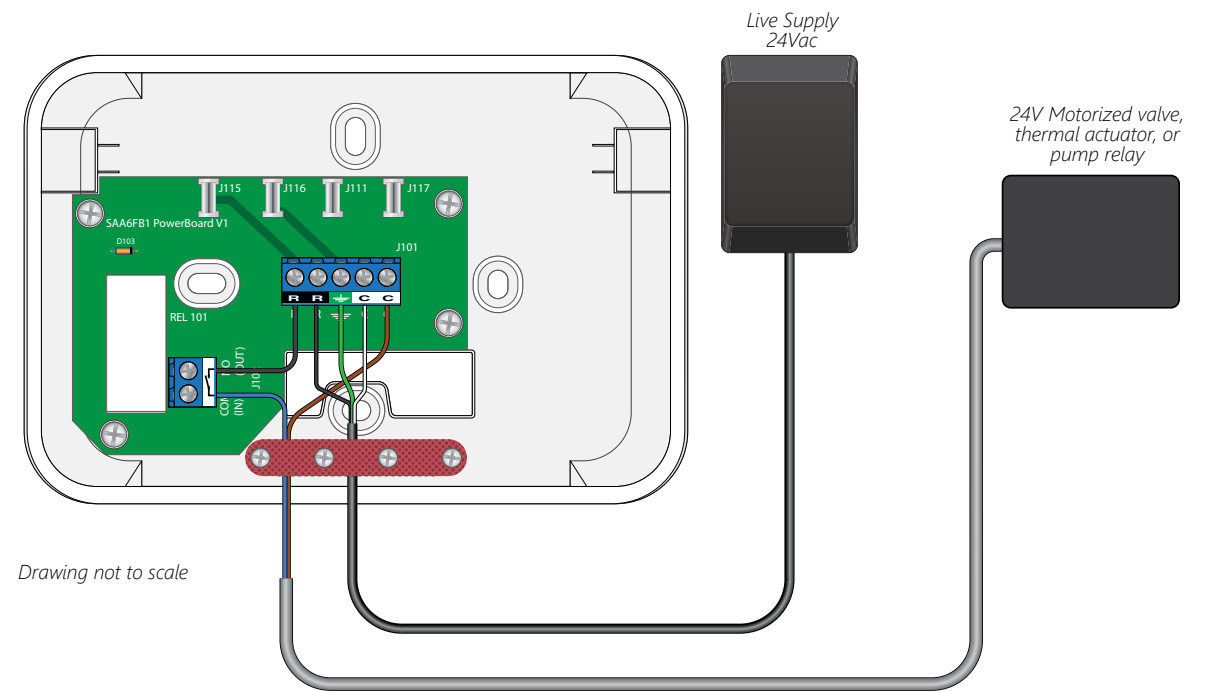

Drawing not to scale

## Installation

The HeatLink Wireless Relay can be used as a boiler relay (RX1), or as a single room relay (RX2), and should be installed in a location that is appropriate to its function, and that allows for easy accessibility for wiring and maintenance.

**Step 1** Remove the cover by loosening the screws on the bottom of the wireless relay.

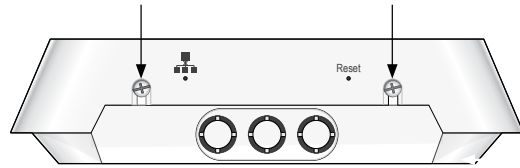

**Step 2** Before pairing the Wireless Relay with your system ensure that the RX1/RX2 switch is in the desired position. (see reverse for details)

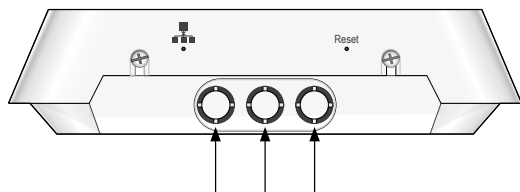
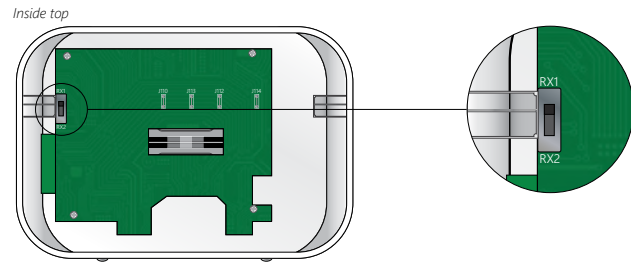

**Step 3** Remove the plastic knockouts on the bottom of the unit as necessary using wire snips, secure wiring with the strain relief.

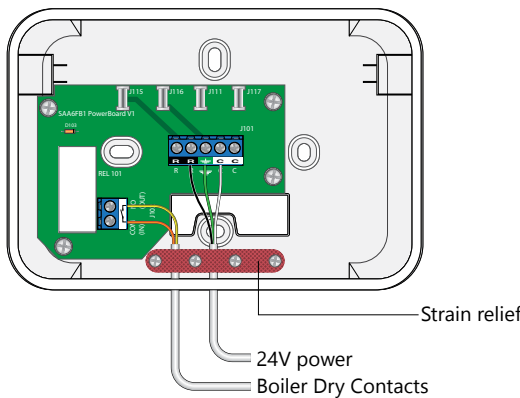

**Step 4** Wire the relay for the required function (see reverse for details).

**Step 5** Use the included screws and wall anchors to mount the receiver to the wall in the desired location, verifying that it is within reach of the power supply and wiring needed.

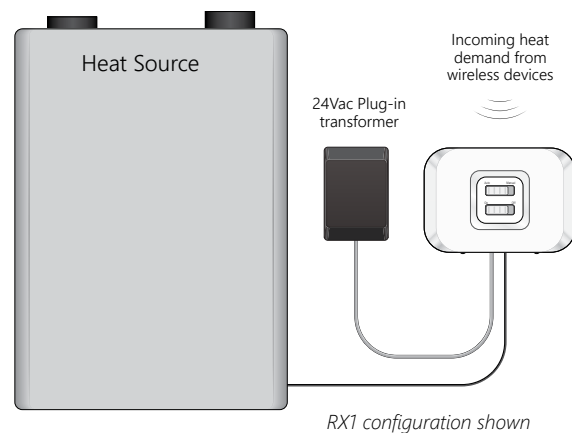

**Step 6** Once wired to your boiler or other device, it is ready to be paired with the system.

## Pair Mode

In order to add devices to your system, the Gateway must be put into Pair Mode. The steps are slightly different for Online and Offline systems - ensure that you follow the instructions below. For device specific pairing instructions, see the appropriate instruction sheet, or the L3715 Smart System Installation Manual, available on [www.heatlink.com](http://www.heatlink.com)

**Online**

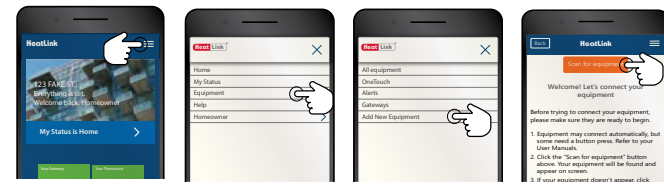

**Offline**

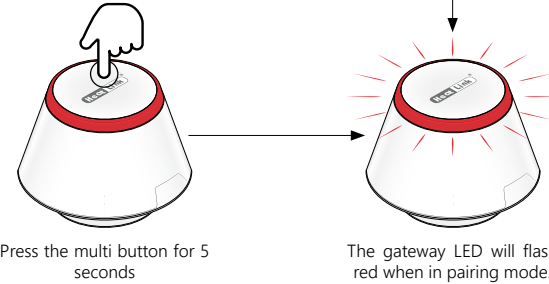

**Plug in the Wireless Relay.**



Both LEDs will flash.

The relay will automatically pair; the red LED will go solid, and the green LED will go off.

When using the relay in RX2 mode you must pair it to a dedicated thermostat by setting the thermostat to REC2.

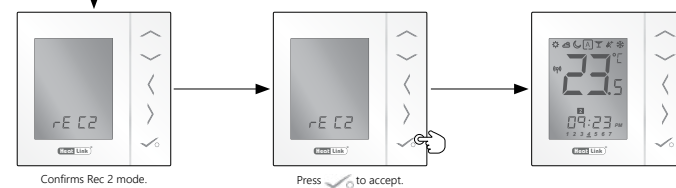
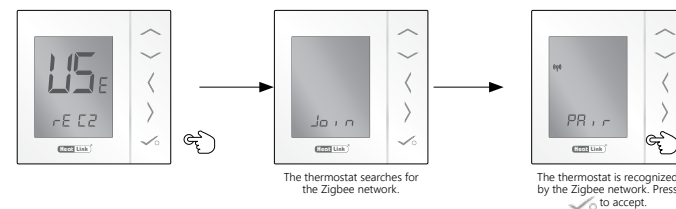

You can also dedicate a relay (RX1) to a single thermostat if needed.

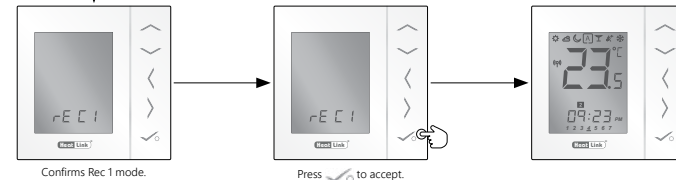
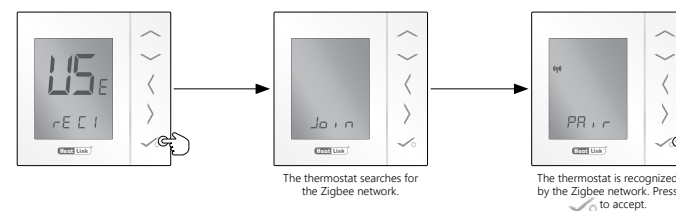

## Mode - RX1

In RX1 mode the wireless relay is used as a boiler receiver, and is wired to the boiler to turn it off or on using the Zigbee signal from either a dedicated wireless thermostat, or any device on the Zigbee network, such as the 8 zone wireless module, a wireless valve actuator, or a relay in RX2 mode.

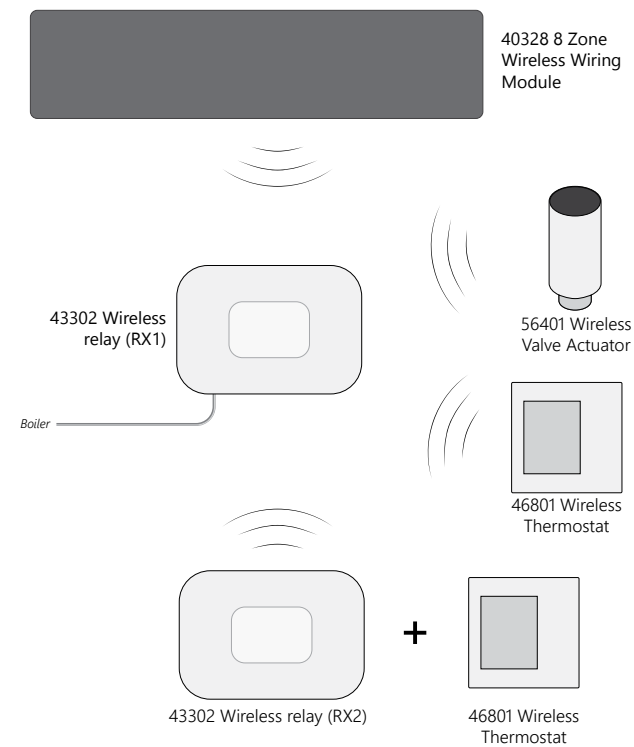

## Mode - RX2

In RX2 mode the wireless relay is used as single room receiver, and is switched on by a signal from a paired 46801 HeatLink® wireless thermostat, and is hardwired to a valve motor, thermal actuator, or pump, depending on the intended use.

It can also be used in conjunction with another wireless relay in RX1 mode, allowing the signal from the RX2 relay to switch on the boiler.

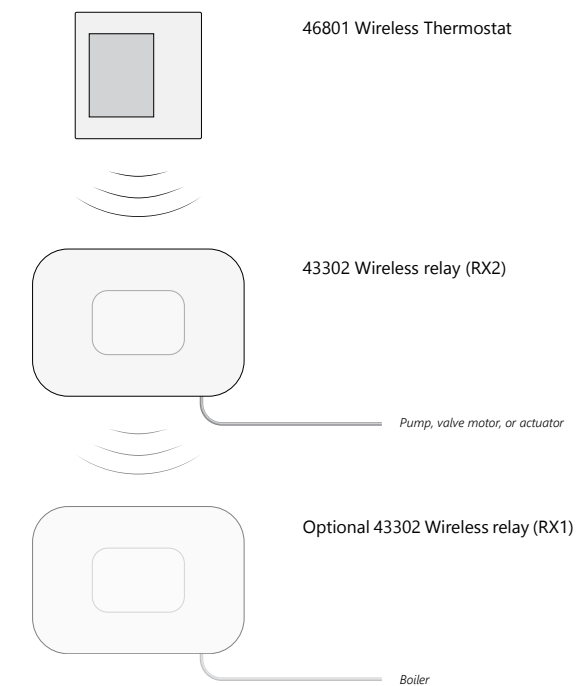

## Electrical Connections

COM	Common contact (volt free input)
NO	Normally Open contact (volt free input)
(Ground)	Ground
R	Incoming mains - Live
C	Incoming mains - neutral

## Technical Details

Model	43302 Wireless Relay
Type	Wired system receiver/relay designed for 24VAC heating applications
Control	ON/OFF control
Environmental Ratings	
Operating temperature	0°C to +50°C / 32°F to 122°F
Storage temperature	-20°C to +60°C / -4°F to 140°F
Operating humidity	5-95% RH
Switch voltage	0-24VAC 16AMP
Power Source	24VAC 60Hz
User interface	Slide switch, LED, Red/Green
Frequency	2.45 GHz
Approval	FCC and IC

## Functions

The wireless relay can be operated in Auto or Manual mode. When in Auto Mode, it will turn the boiler (RX1) or valve motor/pump/actuator (RX2) On/Off when it receives a signal from the thermostat or other input device. When in Auto mode the On/Off switch does not operate.

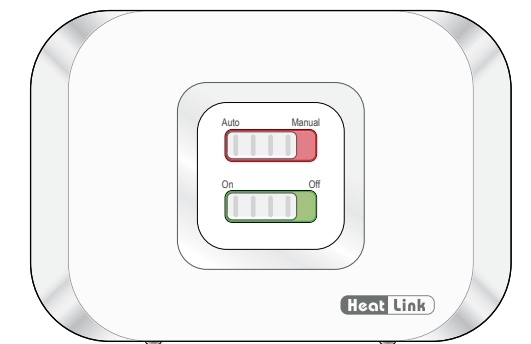

When in Manual Mode, the relay is operated only by the On/Off switch, and will send a signal to the connected device when the switch is in the On position.

## Reset Wireless Relay

If the relay stops operating, press the reset button using a pin or similar.

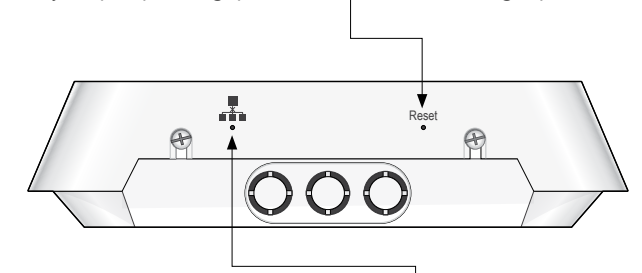

If needed, press the "delete from network" button for 10 seconds using a pin or similar to remove the relay from your Smart System.

The relay can then be inspected, replaced, or re-paired to the system if desired.