

Dear Customer,

We would like to congratulate you on choosing this high quality product. Combining function and design is a sensible and important consideration when selecting a room temperature thermostat. Our thermostats offer a very accurate and reliable operation complete with an interesting and eye-catching (as well as architecturally pleasing) design.

Our electronic room thermostats are specifically designed to work with hydronic heating systems (ie. for use with in-floor radiant heating, baseboards, radiators, and convection panel systems). When used in conjunction with our wax based zone drive operators, they maintain a precise setpoint with minimal fluctuation above and below the setpoint.



Standard Thermostat (#46151)
Setback 3 Position Thermostat (#46153)
Timer Thermostat (#46155)

Innovations include:

- Simple installation,
- Easy operation,
- Optimized assembly,
- Excellent serviceability,
- Top class comfort control with 1/4° temperature adjustment!

Thermostat Mounting Location Recommendations

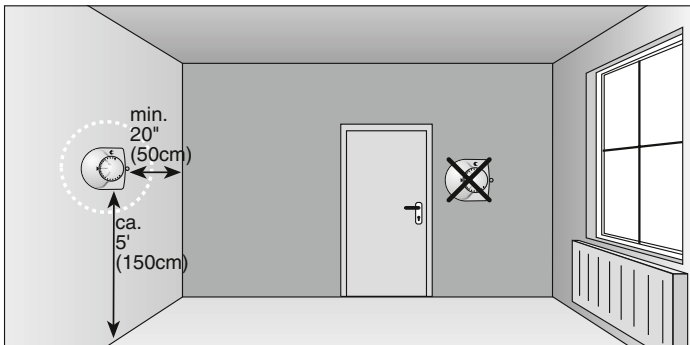

- No higher than 5' (150 cm) off floor
- Minimum 20" (50 cm) from an outer wall
- Do not mount on an outer wall
- Away from door openings
- Away from any direct heat or light source
- Do not cover; allow complete air circulation
- Keep away from moisture

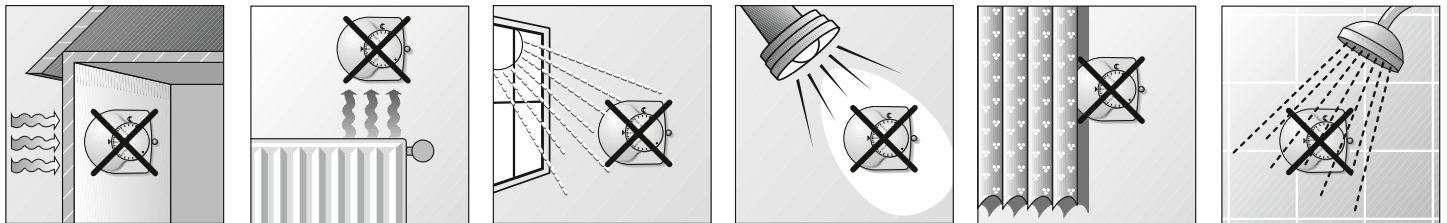

Dimensions in inches and mm



Standard

Setback 3 Position

Timer

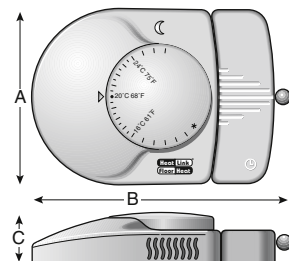
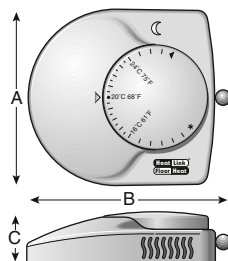
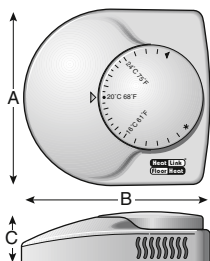

Dimension	A		B		C	
	in	mm	in	mm	in	mm
Standard	3 1/8	79	3 3/8	84	1 1/8	27
Setback 3 Position	3 1/8	79	3 3/4	93	1 1/8	27
Digital Timer	3 1/8	79	4 3/4	118	1 1/8	27

Installation and Assembly

Wall Plate and Thermostat Mounting



The electrical installation must be carried out by a certified technician in accordance with national, and local electrical & safety codes.

Use StatLink® Crimping Pliers (#44200)

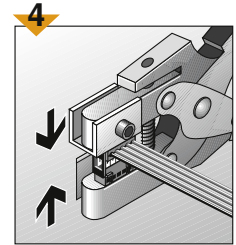
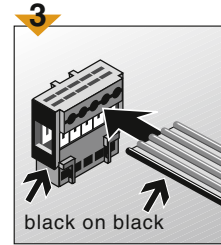
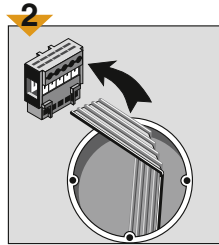
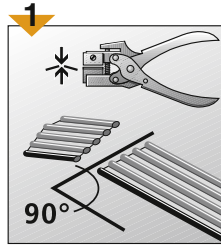
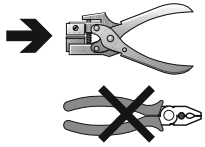

1. Cut StatLink® 5 - Wire Flat Cable (#43005) at 90° angle with StatLink® Crimping Pliers (#44200).
- 2,3. Match the black side of the wire with the black side of the StatLink® 5 - Wire Plug (#43205) and insert.
4. Use StatLink® Crimping Pliers to connect the plug and wire together.

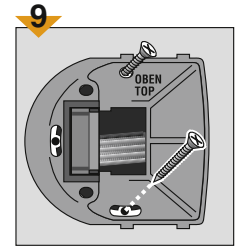
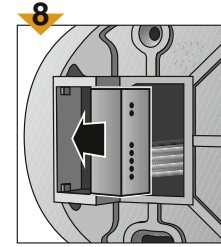
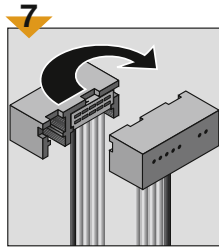
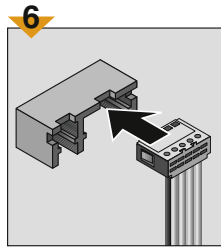
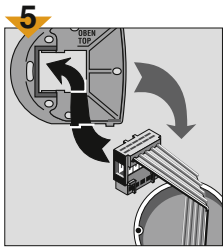

5. Ensure wire and plug can be recessed into the wall without pinching the thermostat wires.
- 6-8. Install plug into thermostat base with terminal connections facing to the right.
9. For mounting the base onto the wall, **only use countersunk screws**.

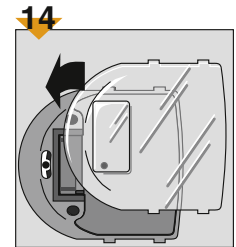
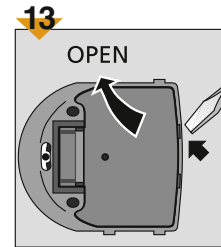
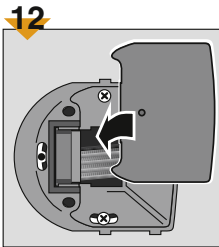
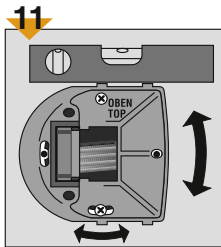
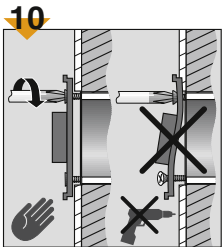

10. **Ensure screws are recessed flush into base** so that the locking plate (see diagram 12) can be installed properly; **do not over-tighten where the base is deforming**; base must sit flush and straight on wall!
11. Use a level if necessary to ensure base is installed properly.
12. After base is installed, **install locking plate**. *Do not install without locking plate. The plate's function is to keep the plug in position and locked as the thermostat is removed from the base.*
13. For removal of the locking plate, use a small flat head screwdriver in notches as indicated.
- 14,15. If the thermostat base has been installed before the all drywall taping or painting has been completed, the clear plastic dust/paint protective cover can be installed.

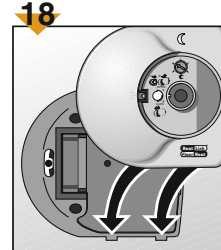
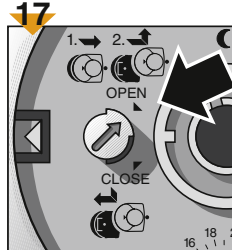
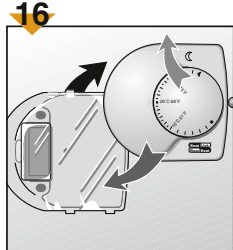
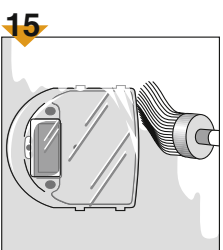

16. For permanent mounting of thermostat, remove clear plastic dust/paint protective cover from base, and remove dial from thermostat to access lock screw underneath.
17. Ensure lock screw is in the open position.
18. Line up thermostat body to the base notches.
19. Slide the thermostat to the left until the thermostat pins are connected securely to the base plug. (Note: do not use force; if the thermostat is difficult to slide, check position of base, lock screw, locking plate, & wire plug to ensure everything lines up & is flush).

Installation and Assembly

Wall Plate and Thermostat Mounting

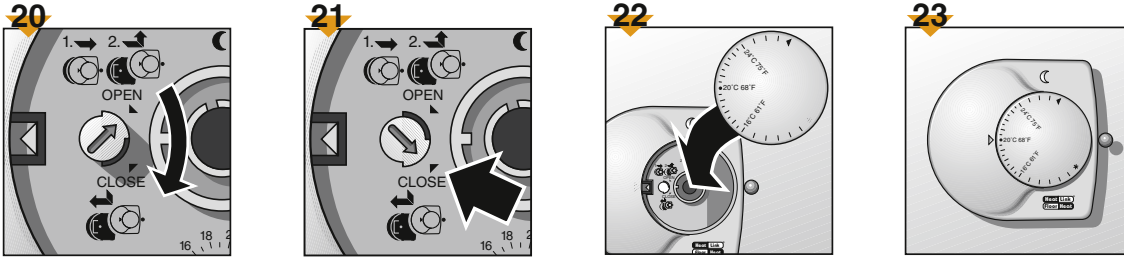

- 20,21. Lock thermostat to base by turning locking screw clockwise to the “close” position.
 22,23. Reinstall thermostat dial.

Operating Panel

Nominal Temperature Setter



Temperature scale in °C/°F.
 Nominal temperature setter with “soft-click.”

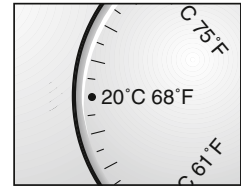
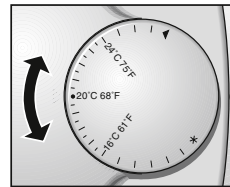
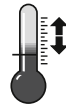

Temperature Range Dial Locking Option

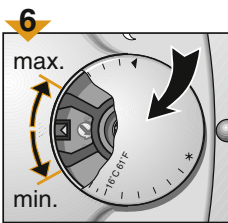

Conversion Chart	
16°C	61°F
18°C	64.5°F
20°C	68°F
22°C	71.5°F
24°C	75°F

1. To lock and/or limit the temperature range on the thermostat dial, remove dial.
2. Underneath the dial there are two removable limit setters.
3. Place the first setter lever on the maximum temperature desired.
4. Place the second setter lever on the minimum temperature desired.
5. Setter levers can be positioned to provide as wide or narrow of a temperature range as desired. (Note: An almost complete lock with only a 0.25° temperature adjustment is possible if desired.)
6. Replace dial and confirm temperature range is set correctly.

Temperature Setback Indicator



When the selection switch has been moved to the “ON” or “AUTOMATIC” position, temperature setback is possible. When temperature setback is in operation, the moon will be illuminated.

Selection Switch

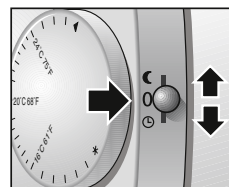

- ☾ Temperature setback “ON” (continual permanent setback)
- 0 Temperature setback “OFF” (continual normal heating operation)
- ⌚ Temperature setback “AUTOMATIC” (as per timer)

Internal Adjustments

Temperature Setback (Non-adjustable)



When a standard thermostat receives a setback signal from a timer switch or a remote digital timer thermostat, the temperature setback amounts to approx. 7.2°F (4°C) of the set point temperature.

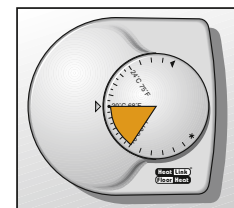
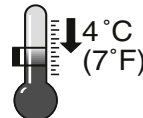

Temperature Setback (Adjustable)

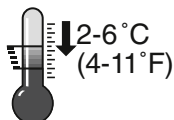

With the setback thermostats (ie. the setback 3 position or timer thermostats) can be varied by 3.8-10.8°F (2-6°C) of the set point temperature.

(Note: Automatic temperature setback is only possible with an external timer switch or a digital timer thermostat.)

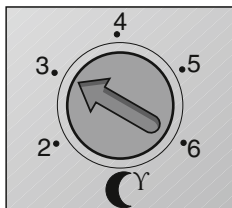
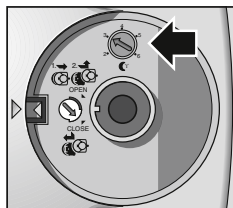

Conversion Chart	
2°C	3.6°F
3°C	5.4°F
4°C	7.2°F
5°C	9.0°F
6°C	10.8°F

Service

Fuse Exchange

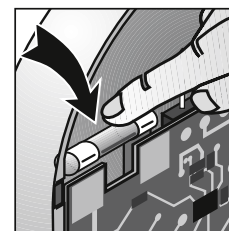
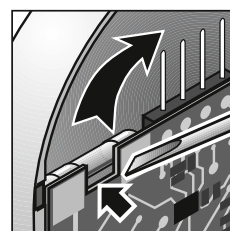
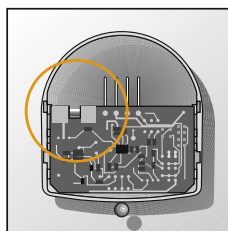
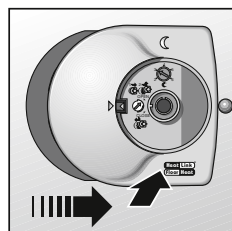
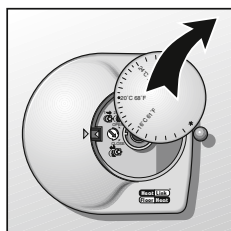

The fuse classification is 1.0 A at 24 V AC.

Technical Data

Functions Chart



General Notes



	Standard	Setback 3 position	Digital Timer
Operating Panel:			
Nominal temperature setpoint 50-82° F (10-28° C) with "soft click"	●	●	●
Large temperature scale with grade positioning	●	●	●
Operating status indicator with illuminated symbol		●	●
Selection switch for selecting operating mode		●	●
Internal Adjustments:			
Range limitation of the setpoint temperature	●	●	●
Temperature setback: 7.2° F (4° C) (non-adjustable)	●		
Temperature setback: adjustable 3.6-10.8° F (2-6° C)		●	●
Removeable digital timer, manual programming, 100h reserve			●
Technical Data:			
Operating voltage 24 V AC	●	●	●
Electronic switching output			
Switch current: max 1A*	●	●	●
Number of zone operators max. 5	●	●	●
"Automatic" temperature setback	●	●	●
"Automatic" program transmitting (pilot clock function)			●
Switching temperature differential: ca. 0.4° F/0.2° C	●	●	●
Contactor type/Contactor class casing: IP 30	●	●	●
Assembly: StatLink plug-in connection	●	●	●

* resistive load

Temperature Setback

The actual setback in temperature of a room with activated setback depends on the insulation of the building and the length of time that the setback is in operation.

Technical Data

Storage temperature	-13...140°F (-25...60°C)
Ambient temperature	-13...104°F (-25...40°C)
Ambient humidity	max. 80% relative humidity, non-condensing

Heat Link Canada

Manufactured & distributed by HeatLink Group Inc.

Head Office:
Toll Free: 1-800-661-5332
Phone: (403) 250-3432
Fax: 1-866-450-1155

Mississauga Office:
Toll Free: 1-800-661-5332
Phone: (905) 795-8289
Fax: 1-866-450-1155

Heat Link China

Distributed by Cathay-Links International
Phone: 852-25693213
Fax: 852-25359271

Heat Link Ireland

Distributed by Jamoni Ltd.
Phone: 057 - 932 4062
Fax: 057 - 932 4063
Freephone: 1800-311338

Heat Link México

Distributed by Distribuidora Caisa S.A. de C.V.
Phone: (52) 3300-4400
Fax: (52) 3300-4406

Heat Link USA

Distributed by HeatLink Group Inc.
Toll Free: 1-800-661-5332
Fax: 1-800-869-6098

www.heatlinkgroup.com