

# Instructions for Installation

## Side Stream Filter

The 02125 Side Stream Filter can be used on systems up to 600,000 BTU.  
5-10% of volume flow should be directed through filter for effective filtration.  
Maximum operating temperature: 158°F (70°C)

### CAUTION !

When installing **do not** crosstread.  
Use precautions when soldering or  
applying heat within 16".

## Installation Method

- Install on low temperature circuit.
- Requires additional 5-10% flow.
- Valves are mandatory.
- Method 2 is specifically for use with panels.

Method 1

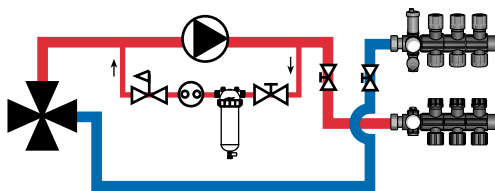

Method 2

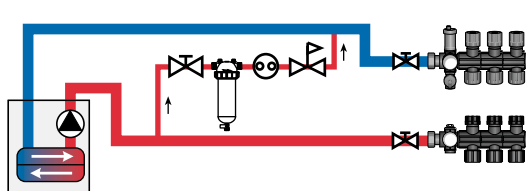

### Legend:

	Side Stream Filter #02125
	isolation (ball) valve
	balancing valve
	flow indicator

## Maintenance

The 02125 Side Stream Filter should be cleaned on an annual basis. The filter can be disassembled, the plastic disc cartridge washed with water, and then reassembled.

- Isolate side stream filter.
- Place bucket under side stream filter and open drain valve.
- Unlatch the side stream filter using the hook wrench.
- Disassemble side stream filter and rinse the "disk filter" thoroughly.
- Reassemble and tighten latch with the hook wrench.
- Close side stream filter drain valve & engage side stream.

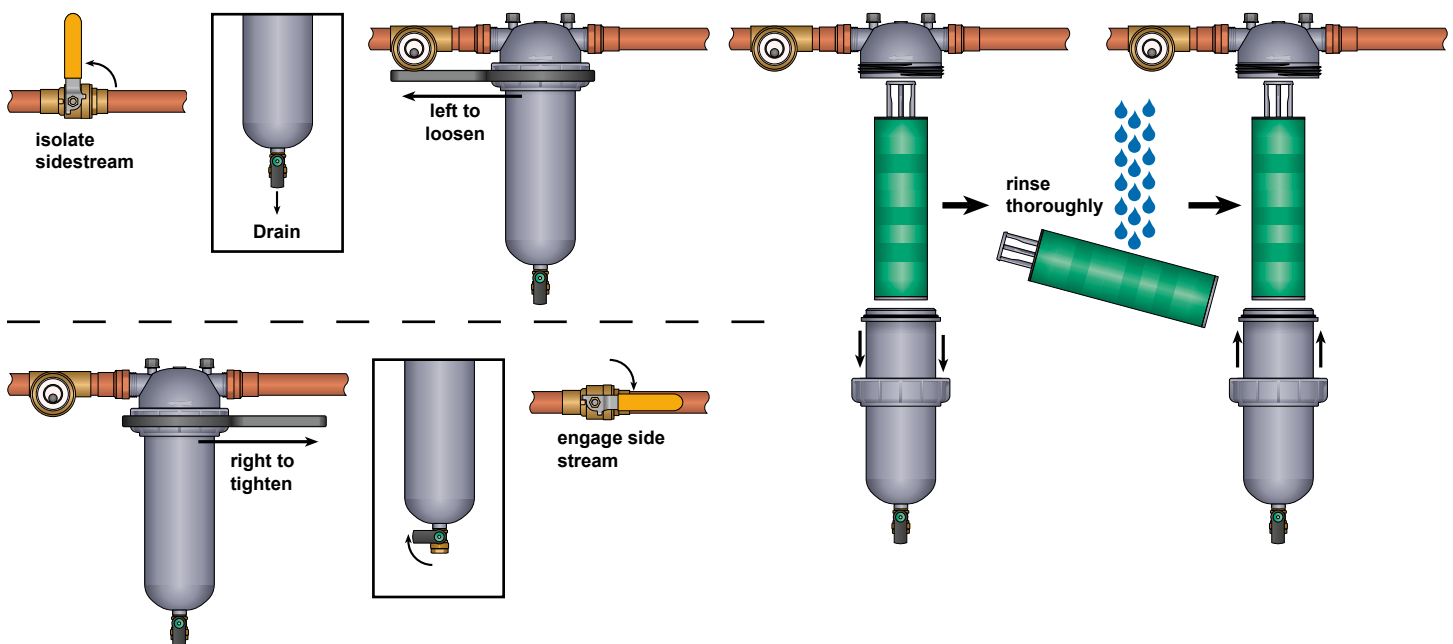

# Instructions for Installation

## Side Stream Filter

### Pressure Loss Chart

