

Technical Data

Material:

- Manifold: Stainless Steel AISI 304
- Mounting Brackets: Zinc Plated Steel
- Hosebib: Nickel Plated Brass
(CW 617N - UNI EN 12165/16)
- Ball Valves: Nickel Plated Brass
(CW 617N - UNI EN 12165/16)
- End Connections: Stainless Steel
- O-rings: EPDM
- Maximum Trunk Flow Rate: 50 US gpm (11.4 m³/h)
- Branch Pair Cv: 6
- Max Working Pressure 145 psi (10 bar)
- Max. Working Temperature 212°F (100°C)

Manifold Assembly:

1. Place the supply manifold (red handles) in the appropriate mounting bracket support (top shown) of each bracket. The brackets should be placed as close to the ends of the manifold as possible. Close the mounting bracket supports and tighten the screw to secure the manifold in place.
2. Place the return manifold (blue handles) in the other mounting bracket support (bottom shown). Close the mounting bracket support and tighten the screw to secure the return manifold in place. Repeat with the second mounting bracket.
3. Lubricate the o-ring and threads of the closed ends and open end adapters with the supplied o-ring lubricant.
4. Screw in the closed ends and open end adapters in the appropriate positions depending on how the manifold will be fed (left, right, or reverse return). Ensure that the o-rings are clean and take care not to pinch them.
5. Place the manifold in its mounting position and screw the mounting brackets to the wall.

Note: Use a backup wrench on the open end adapter when tightening a fitting onto it.

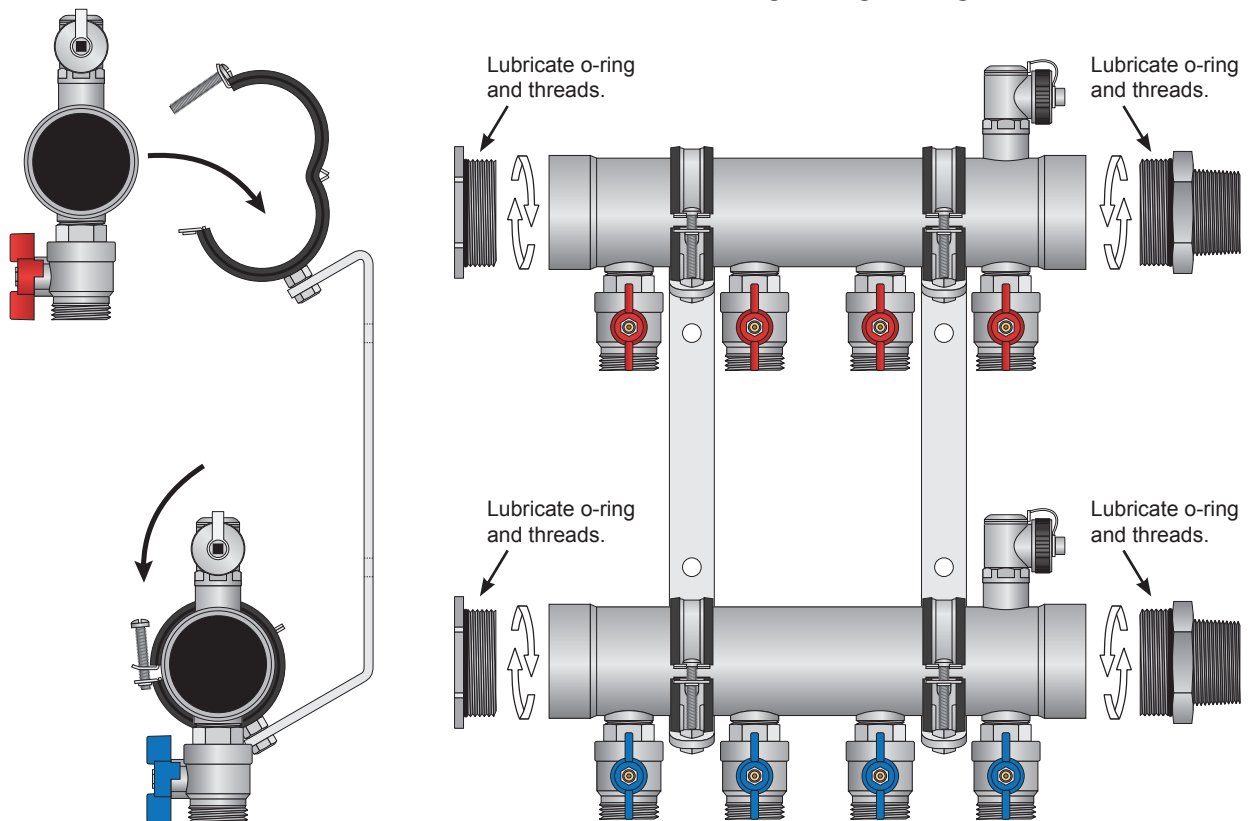

PEX to 2" SS Manifold Connection using 2" PEX to Manifold Connecters (sold separately)

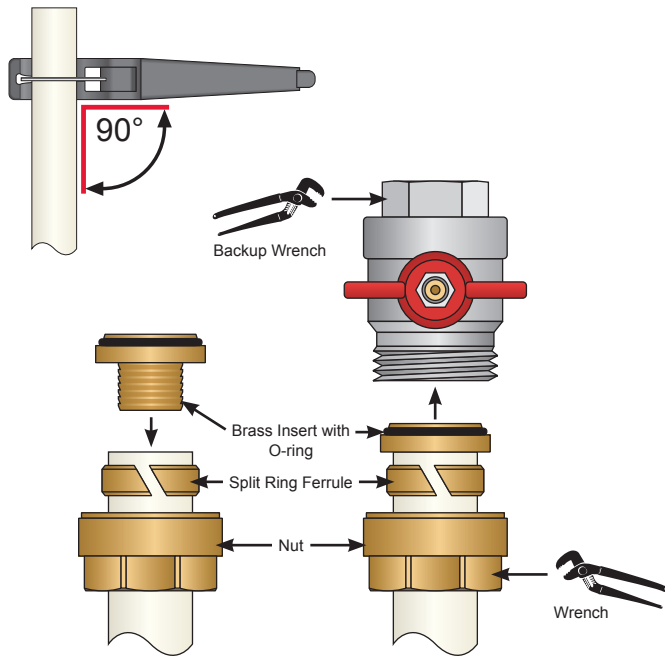

1. Lubricate the inside of the ball valve with silicone o-ring lubricant (#79952).
2. Cut the PEX tubing at a 90° angle.
3. Place the Nut and Split Ring Ferrule onto the PEX tubing.

Method A

5. Push the Brass Insert onto the PEX tubing as far as it will go.
6. Push the PEX tubing with Brass Insert as far as it will go into the ball valve. Ensure the o-ring is clean and take care not to pinch it.

Method B

5. Push Brass Insert as far as it will go into the ball valve. Ensure the o-ring is clean and take care not to pinch it.
6. Push PEX tubing onto the Brass Insert as far as it will go.
7. Tighten the nut with a wrench. Use a backup wrench on the valve.
8. For 1" fittings, please see the "Potable Installation Guide" (L3235) for instructions on press connections.

General Guidelines

Please review the instructions and warranty carefully. Assembly and installation are the installer's responsibility and beyond HeatLink's control.

1. Assemble the manifold under clean conditions. Any dirt on the o-rings may compromise seal. Ensure the o-rings are clean.
2. Brace or support the supply and return mains parallel to the manifold and centered with the manifold's inlet and outlet. This will prevent stress and possible damage on the manifold supply and return end connections.
3. Use precautions when soldering or applying heat within 24" of the manifold.
4. Use ball valves in front of manifold for servicing requirements.
5. Protect the manifold during all phases of construction using a polyethylene sheet or an enclosure.
6. Retighten the PEX to manifold connector nuts after the first week of system operation. Use a backup wrench on the valve.

7. Do not use 2" Stainless Steel manifolds and accessories for purposes other than those for which they were designed. Do not exceed their specifications. Failure to follow these guidelines or the product's instructions will void the warranty.
8. In case a leak develops during testing, remove pressure from system. If the leak is:
 - a) at o-ring connections, clean the o-ring, and reapply silicone lube.
 - b) between the manifold and valve, use Loctite 55 pipe sealing cord (#76601).
9. A water analysis is recommended for every installation site. For warranty claims a water analysis is mandatory.
10. Consult with your HeatLink® dealer or distributor if you have any questions regarding the operations and limits of HeatLink products. Review all instructions and warranty information carefully.

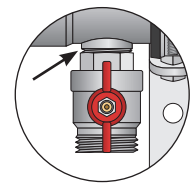

Warranty

Refer to the HeatLink Limited Heating Warranty.