

Job or Customer :	
Location :	
Engineer :	
<input type="checkbox"/> Complies with Spec <input type="checkbox"/> Alternate	Notes :
Contractor :	
HeatLink Rep :	
Submitted By :	Date :
Approved By :	Date :
P.O. Number :	Date :

Description

Solid brass fitting attaches to the end of the PEX tubing and allows for easy installation onto the bottom of the manifold. Packaged in pairs.

Pair Qty	Stk. #	PEX Size	Dim A	Dim B, in/(mm)	Dim C, in/(mm)	Dim D		Weight (pair), lb/(kg)
	77519	5/8"	G 1"	0.764 (19.4)	0.559 (14.2)	EK25	1.34 (34)	0.40 (0.18)
	77522	3/4"	G 1"	0.882 (22.4)	0.661 (16.8)	EK25	1.34 (34)	0.37 (0.17)

Technical Data

	Specifications
Material - Metal Components	Brass ASTM B124 C37700 (CW617N)
Material - O-ring	EPDM
Max Operating Pressure	100 psi (6.9 bar)
Operating Temperature	160°F (70°C)
Max Temperature	195°F (90°C)
Min Operating Temperature	36°F (2°C); 0°F (-18°C) with anti-freeze

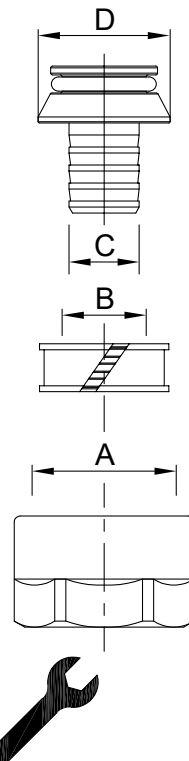

Installation

Installation must follow all of HeatLink's instructions and guidelines.

Maintenance

Maintenance must follow all of HeatLink's instructions and guidelines.

Related Documents

- 1-1/2" Stainless Steel Manifold Assembly Instructions (L676700)
- HeatLink Limited Heating Warranty

This page is intentionally blank.